

(KHC 2011-1)

RESOURCE # TAC-291

EVALUATION N / Eligible: member of a group

SHPO EVALUATION \_\_\_\_\_

DESTROYED \_\_\_\_\_

1. NAME OF RESOURCE (how determined):  
4 / Original or later significant uses of the property  
Armory Building

2. ADDRESS/LOCATION:  
206 N. Central Avenue  
Campbellsville, KY 42718

3. UTM REFERENCE:  
Quad Name: Campbellsville Date: 1970 PR 1987  
Zone: 16 Method: C / Commonwealth Base Map  
Easting: 646719 Northing: 4134100

4. OWNER/ADDRESS:  
City of Campbellsville  
210 S. Columbia Avenue  
Campbellsville, KY 42718

5. FIELD RECORDER/AFFILIATION:  
Donna Logsdon, Architect

6. DATE RECORDED: 9/7/2012

7. SPONSOR:  
City of Campbellsville & Kentucky Heritage Council

8. INITIATION: 2 / CLG

9. OTHER DOCUMENTATION:  
 Survey  HABS/HAER  NR  
 KY Landmark

10. REPORT/NR REFERENCE:  
Campbellsville Historic Commercial District

11. ORIGINAL PRIMARY FUNCTION:  
04: Government/Public - K: Other

12. CURRENT PRIMARY FUNCTION:  
04: Government/Public - K: Other Community  
Recreation Center

13. CONSTRUCTION DATE: Estimated 2: 1950-1974  
Documented: 1960s

14. DATE OF MAJOR ADDITIONS/MODIFICATIONS (specify):  
\_\_\_\_\_

15. CONSTRUCTION METHOD AND MATERIAL:  
Original/Primary: B0 / Brick  
Subsequent/Secondary: \_\_\_\_\_

16. DIMENSIONS: Height: C: 2 Story

Width: 6 Depth: 1 Acreage:

27. SUPPORT RESOURCES:

17. PLAN:  
First: U / Undetermined/not applicable  
Second: \_\_\_\_\_

18. STYLISTIC INFLUENCE:  
First: 5:7: Other No style  
Second: \_\_\_\_\_

19. FOUNDATION:  
Type: 2 / Continuous  
Material: B / Brick

20. PRIMARY WALL MATERIAL:  
Original: C / Brick veneer  
Replacement: \_\_\_\_\_

21. ROOF CONFIGURATION AND COVERING:  
Configuration: Q / Flat  
Covering: 6 / Built-up (tar)

22. CONDITION:  
G / Good-in good state of repair

23. MODIFICATION: 1 / Little or no alteration

24. ARCHITECT/BUILDER:

25. PHOTOGRAPH FILE:  
TAC291\_01, TAC291\_02

26. WINDOWS: Original  Replacement   
Type: Metal Casement

TAC291\_01



COMMENTS/HISTORICAL INFORMATION:  
This building is a community recreation center.

SITE PLAN KEY	FUNCTION	CONSTRUCTION DATE	METHOD/MATERIAL
		_____	_____
		_____	_____
		_____	_____
		_____	_____
		_____	_____
		_____	_____
		_____	_____

28. SITE PLAN (Complete if #26 was answered or if you are using sub-numbers):

29. MAP (Scan or attach copy of map showing exact location of resources): TAC-291      Map C05-25-04

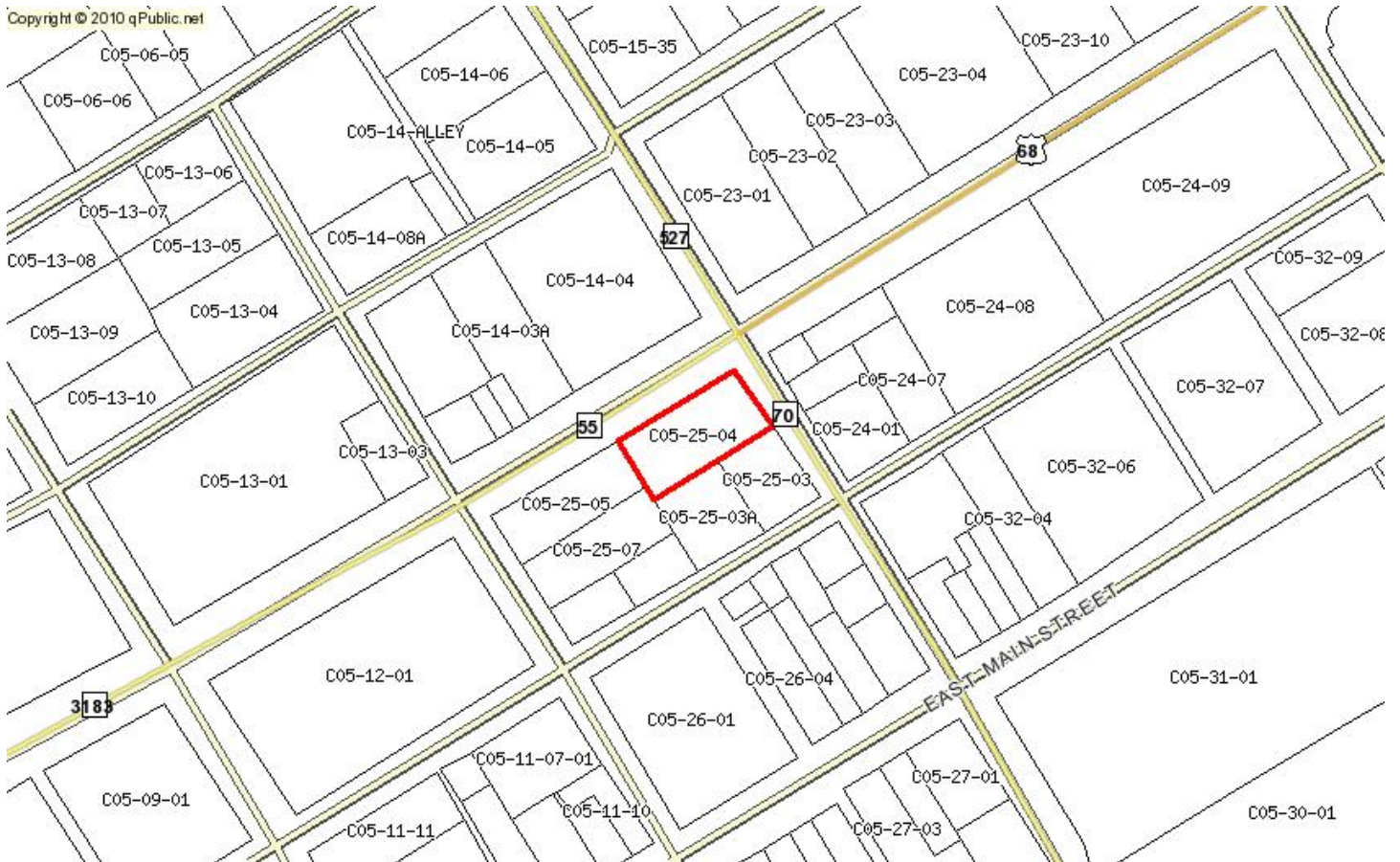



TAC291\_02