

(KHC 2011-1)

RESOURCE # TAC-292

EVALUATION N / Eligible: member of a group

SHPO EVALUATION _____

DESTROYED _____

1. NAME OF RESOURCE (how determined):
4 / Original or later significant uses of the property
Beard's Service Station; Taylor Co. Tourist Info. Center ;
Best Financial Service

2. ADDRESS/LOCATION:
325 E. Main Street
Campbellsville, KY 42718

3. UTM REFERENCE:
Quad Name: Campbellsville Date: 1970 PR 1987
Zone: 16 Method: C / Commonwealth Base Map
Easting: 646868 Northing: 4134143

4. OWNER/ADDRESS:
Taylor County Bank
P.O. Box 200
Campbellsville, KY 42719

5. FIELD RECORDER/AFFILIATION:
Donna Logsdon, Architect

6. DATE RECORDED: 9/7/2012

7. SPONSOR:
City of Campbellsville & Kentucky Heritage Council

8. INITIATION: 2 / CLG

9. OTHER DOCUMENTATION:
 Survey HABS/HAER NR KY Landmark

10. REPORT/NR REFERENCE:
Campbellsville Historic Commercial District

11. ORIGINAL PRIMARY FUNCTION:
16: Transportation - D: Road (vehicular) related

12. CURRENT PRIMARY FUNCTION:
02: Commercial - D: Financial institution and Taylor
County Tourist Commission

13. CONSTRUCTION DATE: Estimated 2: 1950-1974
Documented: 1950s

14. DATE OF MAJOR ADDITIONS/MODIFICATIONS (specify):
A: 2001-Present 2010 building renovated into a
financial institution and Tourist Commission Office

15. CONSTRUCTION METHOD AND MATERIAL:
Original/Primary: B0 / Brick
Subsequent/Secondary: _____

16. DIMENSIONS: Height: A: Single Story

Width: 4 Depth: 2 Acreage:

17. PLAN:
First: U / Undetermined/not applicable
Second: _____

18. STYLISTIC INFLUENCE:
First: 5:7: Other No style
Second: _____

19. FOUNDATION:
Type: 2 / Continuous
Material: B / Brick

20. PRIMARY WALL MATERIAL:
Original: C / Brick veneer
Replacement: _____

21. ROOF CONFIGURATION AND COVERING:
Configuration: 1 / Hip
Covering: 5 / Asphalt shingle

22. CONDITION:
G / Good-in good state of repair

23. MODIFICATION: 3 / Major unsympathetic alteration

24. ARCHITECT/BUILDER:

25. PHOTOGRAPH FILE:
TAC292_01, TAC292_02

26. WINDOWS: Original Replacement
Type: _____ Metal

TAC292_01



COMMENTS/HISTORICAL INFORMATION:
See continuation sheet

27. SUPPORT RESOURCES:

SITE PLAN KEY	FUNCTION	CONSTRUCTION DATE	METHOD/MATERIAL

28. SITE PLAN (Complete if #26 was answered or if you are using sub-numbers):



29. MAP (Scan or attach copy of map showing exact location of resources): TAC-292 Map C05-32-08

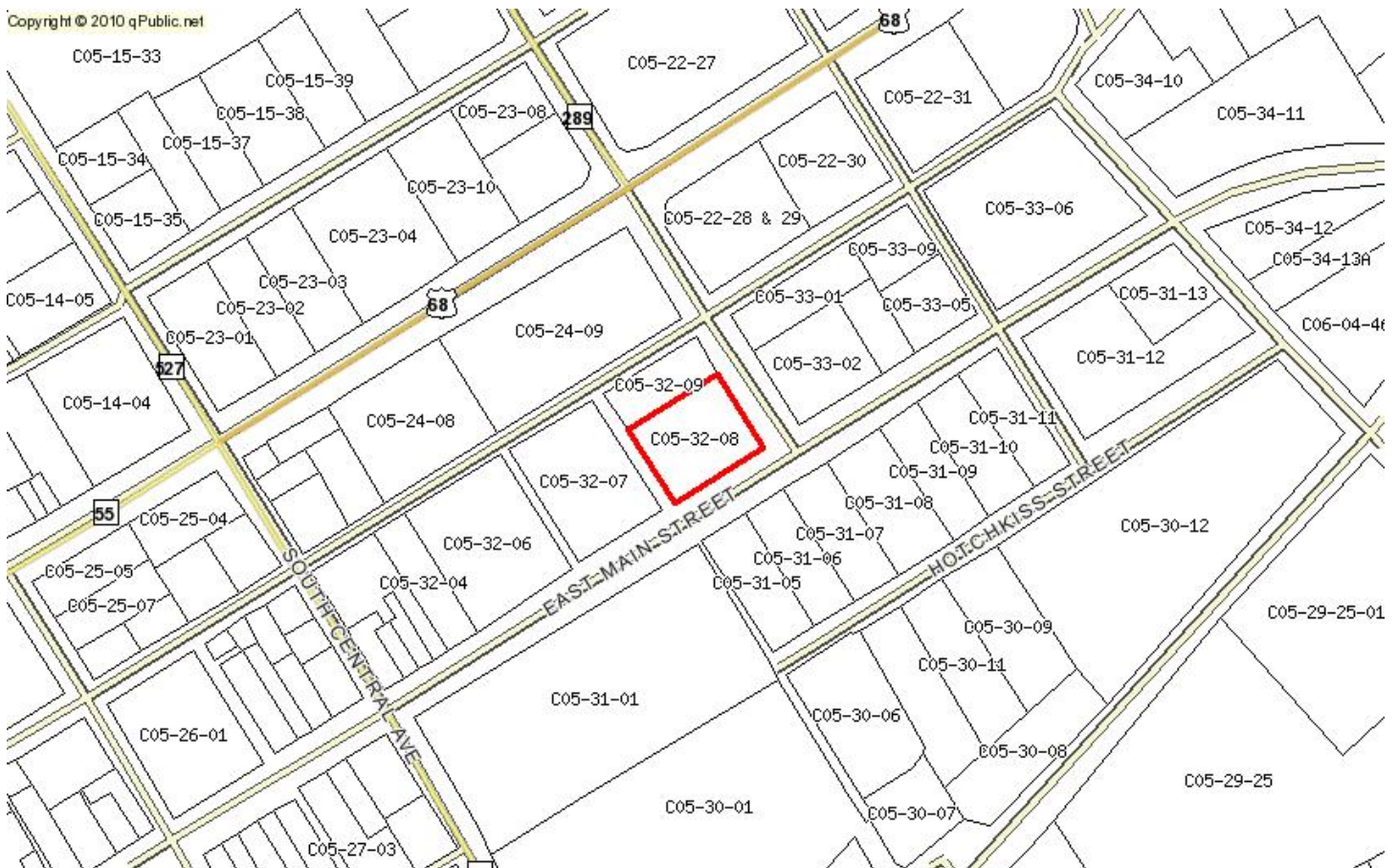



TAC292_02

Beard's Service Station (TAC-292)

The first gasoline station, Standard Oil, built in Campbellsville was located here. Gasoline sold for 29 cents a gallon. The building was renovated in 2008 from a Service Station into Best Financial and the Taylor County Tourist Commission.