

1. NAME OF RESOURCE (how determined):
4 / Original or later significant uses of the property
Druther's Restaurant

2. ADDRESS/LOCATION:
101 N. Columbia Avenue
Campbellsville, KY 42718

3. UTM REFERENCE:
Quad Name: Campbellsville Date: 1970 PR 1987
Zone: 16 Method: C / Commonwealth Base Map
Easting: 646592 Northing: 4133936

4. OWNER/ADDRESS:
Charles & Joann McCarty
206 Shreve Drive
Campbellsville, KY 42718

5. FIELD RECORDER/AFFILIATION:
Donna Logsdon, Architect

6. DATE RECORDED: 9/7/2012

7. SPONSOR:
City of Campbellsville & Kentucky Heritage Council

8. INITIATION: 2 / CLG

9. OTHER DOCUMENTATION:
 Survey HABS/HAER NR KY Landmark

10. REPORT/NR REFERENCE:
Campbellsville Historic Commercial District

11. ORIGINAL PRIMARY FUNCTION:
02: Commercial - G: Restaurant/bar/tavern

12. CURRENT PRIMARY FUNCTION:
02: Commercial - G: Restaurant/bar/tavern

13. CONSTRUCTION DATE: Estimated 2: 1950-1974
Documented: 1970

14. DATE OF MAJOR ADDITIONS/MODIFICATIONS (specify):

15. CONSTRUCTION METHOD AND MATERIAL:
Original/Primary: W2 / Balloon frame
Subsequent/Secondary: _____

16. DIMENSIONS: Height: A: Single Story

Width: 3 Depth: 3 Acreage:

17. PLAN:
First: U / Undetermined/not applicable
Second: _____

18. STYLISTIC INFLUENCE:
First: 5:7: Other No style
Second: _____

19. FOUNDATION:
Type: 2 / Continuous
Material: B / Brick

20. PRIMARY WALL MATERIAL:
Original: C / Brick veneer
Replacement: _____

21. ROOF CONFIGURATION AND COVERING:
Configuration: Q / Flat
Covering: 6 / Built-up (tar)

22. CONDITION:
G / Good-in good state of repair

23. MODIFICATION: 1 / Little or no alteration

24. ARCHITECT/BUILDER:

25. PHOTOGRAPH FILE:
TAC298_01, TAC298_02

26. WINDOWS: Original Replacement
Type: _____ Metal

TAC298_01



COMMENTS/HISTORICAL INFORMATION:

27. SUPPORT RESOURCES:

SITE PLAN KEY	FUNCTION	CONSTRUCTION DATE	METHOD/MATERIAL

28. SITE PLAN (Complete if #26 was answered or if you are using sub-numbers):



29. MAP (Scan or attach copy of map showing exact location of resources): TAC-298 Map C05-10-03

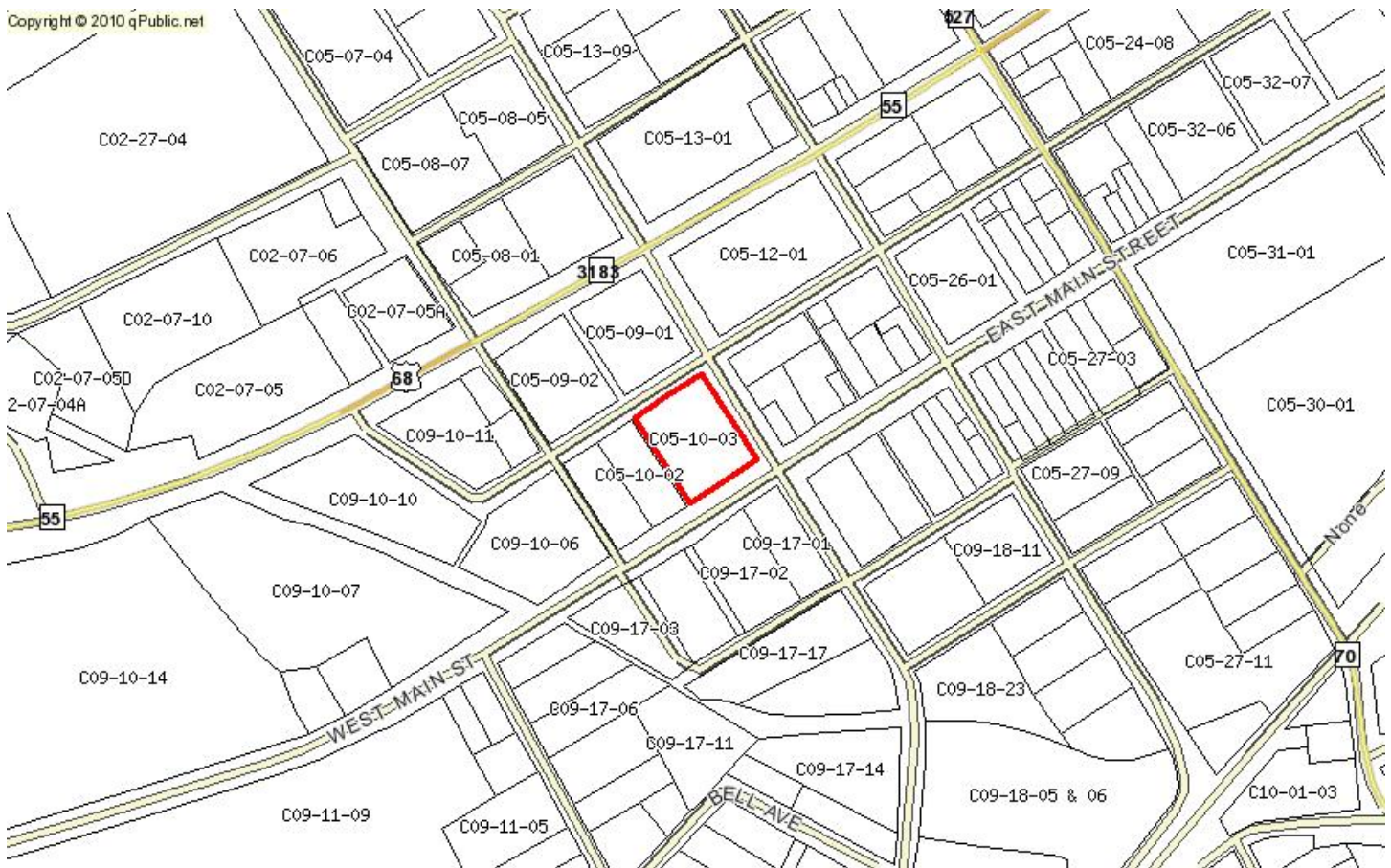



TAC298_02