

**KENTUCKY HISTORIC PROPERTIES SURVEY FORM
2016-1**

COUNTY Taylor

RESOURCE # TAC-429

EVALUATION N/ Eligible Member of a Group

SHPO EVALUATION

Choose One

CONDITION

G / Good - In good state of repair

For SHPO Use Only

1. **NAME OF RESOURCE:** Rodger's Glass & More
HOW DETERMINED: Choose One
2. **ADDRESS/LOCATION:** 113 S. Columbia Ave.
Campbellsville, KY 42718
OWNER CONTACT (if known): Huddleston Pro
247 Burdick School Dr Campbellsville, KY
3. **GEOGRAPHIC DATA:**
Quad: Campbellsville **Date:** 1987
Lat: 37.339484 **Long:** -85.344510
4. **FIELD RECORDER/AFFILIATION:** Donna
Logsdon
Architect
5. **DATE RECORDED:** 10/20/17
6. **SPONSOR/INITIATION:**
2 / Certified Local Govt project
Sponsor Name: City of Campbellsville &
Kentucky Heritage Council
7. **PREVIOUSLY RECORDED:**
0 / Not Previously Recorded
8. **REPORT/NR REFERENCE:** Campbellsville CLG
Survey 2017-2018

9. **ORIGINAL PRIMARY FUNCTION:** 02E:
Specialty store/shop
10. **CURRENT PRIMARY FUNCTION:** 99V:
Vacant abandoned (site extant, but not in
service)
11. **ORIGINAL CONSTRUCTION DATE:**
Estimated: 4/ 1900-1924 **Documented:** 1920s
12. **MAJOR ADDITIONS/MODIFICATIONS (specify):**
Choose One Choose One
13. **MODIFICATION ASSESSMENT:**
Choose One
14. **CONSTRUCTION METHOD AND MATERIAL:**
Original/Primary (if known): P1/ Concrete block
Subsequent/Secondary (if known): Choose One
Other:
15. **EXTERIOR WALL CLADDING:**
Original (if known): B/ Stone veneer
Current: Choose One
16. **DIMENSIONS:**
Height: A/ 1 story **Acreage:**

26. PHOTO A



17. **ARCHITECTURAL FORM/SHAPE:** A/ Square or rectangular
18. **ARCHITECTURAL TYPE (choose from applicable list(s)):**
Early 19th-Mid 19th century types Choose One
Mid-to-Late 19th century types Choose One
Late 19th-Mid 20th century types Choose One
Other U/ Undetermined/not applicable
19. **ARCHITECTURAL STYLE (choose from applicable list(s)):**
Early Republic c. 1780-1835 Choose One
Mid-19th Century/Romantic c. 1835-1880 Choose One
Victorian c. 1840-1910 Choose One
Turn-of-Century Revival Styles c. 1880-1940 Choose One
20th Century American c. 1900-1940 Choose One
Modern c. 1920-Present Choose One
Other O/ Other (specify) No Style

20. FOUNDATION WALLS:

Type: 2 / Continuous

Material: R / Poured Concrete

21. ROOFING:

Configuration: B/ Gable, front

Slope: 2/ Normal - Between 30 and 45 degrees **Roof**

Covering: 5/ Asphalt shingle

22. ARCHITECT/BUILDER (if known):

23. WINDOWS: Original Replacement

Current Material: M/ Metal

Sash Operation: F/ Fixed

Glazing Pattern: M/ Multi-Light

24. NUMBER OF SUPPORT RESOURCES: 0/ None
(If yes, complete #27 and #28 below.)

25. COMMENTS/HISTORICAL INFORMATION (Complete on
Continuation Sheet)

PHOTO B (Place Additional Photos below under 26.
continued)



SHPO Review Date _____

SHPO Data Entry Date _____

COUNTY: Taylor

RESOURCE NUMBER: TAC-429

27. SUPPORT RESOURCES:

SITE PLAN KEY	FUNCTION	CONSTRUCTION DATE	METHOD/MATERIAL
	Choose One	Choose One	Choose One
	Choose One	Choose One	Choose One
	Choose One	Choose One	Choose One
	Choose One	Choose One	Choose One
	Choose One	Choose One	Choose One
	Choose One	Choose One	Choose One
	Choose One	Choose One	Choose One
	Choose One	Choose One	Choose One
	Choose One	Choose One	Choose One
	Choose One	Choose One	Choose One

28. SITE PLAN (Complete if #24 was answered or if you are using sub-numbers):



COUNTY: Taylor
RESOURCE NUMBER: TAC-429

29. MAP (Scan or attach copy of map showing exact location of resources):

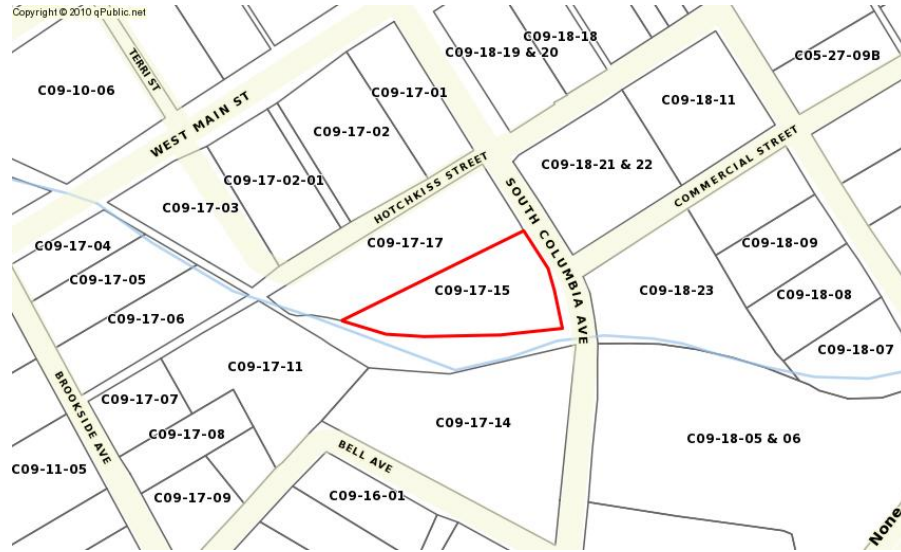

25. (continued) COMMENTS/HISTORICAL INFORMATION:

This one-story stone front building was constructed in the 1920's and has been occupied by Rodgers Glass and More for many years until recently when it was vacated. It has 2,940 SF.

COUNTY: Taylor

RESOURCE NUMBER: TAC-429

26. (continued) ADDITIONAL IMAGES:

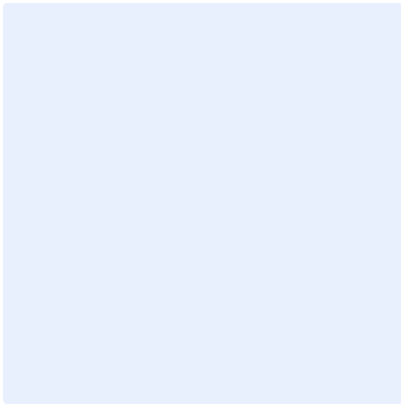

Caption:

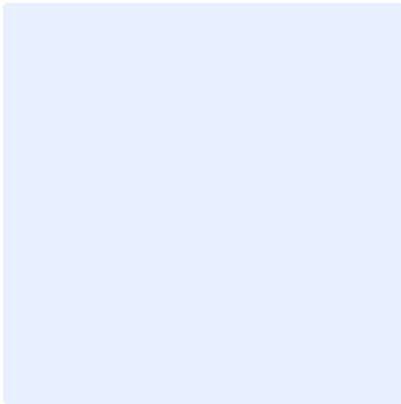

Caption: